



From February 1st, 2017 SAMES Technologies SAS becomes SAMES KREMLIN SAS
A partir du 1/02/17, SAMES Technologies SAS devient SAMES KREMLIN SAS

SAMES  **KREMLIN**



User manual

Fast Clean

SAS SAMES Technologies. 13 Chemin de Malacher 38243 Meylan Cedex
Tel. 33 (0)4 76 41 60 60 - Fax. 33 (0)4 76 41 60 90 - www.sames.com

All communication or reproduction of this document, in any form whatsoever and all use or communication of its contents are forbidden without express written authorisation from SAMES Technologies.

The descriptions and characteristics mentioned in this document are subject to change without prior notice.

© SAMES Technologies 2008



WARNING : Sames Technologies is registered with the Ministry of Labour as a training institution.

Throughout the year, our company offers training courses in the operation and maintenance of your equipment.

A catalogue is available on request. Choose from a wide range of courses to acquire the skills or knowledge that is required to match your production requirements and objectives.

Our training courses can be delivered at your site or in the training centre at our Meylan head office.

Training department:

Tel.: 33 (0)4 76 41 60 04

E-mail: formation-client@sames.com

Sames Technologies operating manuals are written in French and translated into English, German, Spanish, Italian and Portuguese.

The French version is deemed the official text and Sames will not be liable for the translations into other languages.

Fast Clean

1. Safety Regulations	4
2. Description	4
3. Characteristics	4
3.1. <i>General characteristics</i>	4
3.2. <i>Pneumatic characteristics</i>	4
4. Operation	5
5. Tools	5
6. Installation	5
6.1. <i>Fitting "Fast Clean" on an e-Jet or e-Series</i>	5
6.2. <i>Fitting "Fast Clean" on a "Mach-Jet" cart</i>	6
7. Maintenance	6
8. Spare Parts	7

1. Safety Regulations



WARNING : Ensure the compressed air supply is cut off before any maintenance, servicing or cleaning operation on the Fast Clean.
Please refer to the safety regulations for the cart on which the “Fast Clean” is fitted.

2. Description



- The “Fast Clean” can be used to clean the inside of the powder-paint circuit using compressed air, from the CS 237 powder pump up to the “Mach-Jet” spray gun.

3. Characteristics

3.1. General characteristics

Operating temperature	from 0°C to 40°C (32°F to 104°F).
-----------------------	-----------------------------------

3.2. Pneumatic characteristics

Characteristics of the compressed-air supply according to standard NF ISO 8573-1:

Maximum dew point at 6 bar (87 psi)	class 4, i.e. + 3 °C (37 ° F)
Maximum particle size of solid contaminants	Class 3, i.e. 5 µm.
Maximum oil concentration	Class 1, i.e. 0.01 mg/m ₀ ³ *
Maximum concentration of solid contaminants	5 mg / m ₀ ³ *

* : air flow-rate values given for a temperature of 20°C (68°F) and an atmospheric pressure of 1013 mbar.

Air supply pressure	7 bar ± 1 bar (*)
Continuous operation air flow-rate	< 20 m ³ /h



WARNING : (*) Pressure in excess of 8 bar may cause malfunctions.

4. Operation

The “Fast Clean” can be used to clean the inside of the powder-paint circuit using compressed air, simply by pressing the CS 237 powder pump on the “Fast Clean”.

Procedure:

- **Step 1:** Set the CRN 457 control module to cleaning mode ([see RT Nr 6336](#) page 18).
- **Step 2:** Place the powder pump on the “Fast Clean” and press repeatedly. The pressing action releases compressed air to clean the whole powder circuit in just a few seconds.

5. Tools

No specific tools.

6. Installation

6.1. Fitting “Fast Clean” on an e-Jet or e-Series

If the cart does not already have one, drill a 9 mm diameter hole on one side of the “e-Jet” cart, for assembling the “Fast Clean” as shown in the illustration below.

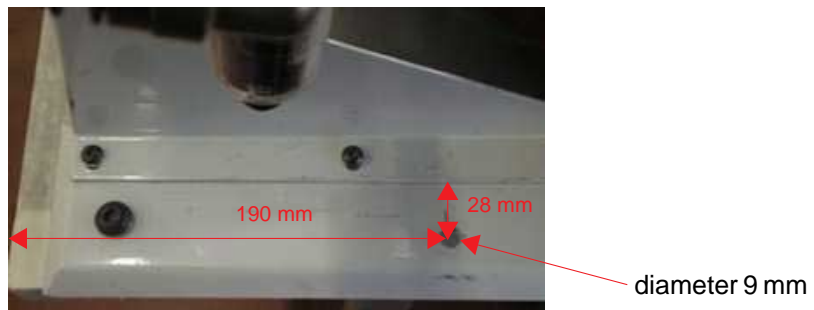

- Secure the “Fast Clean” with an M8 x 16 screw and external tooth lock washer, ([see § 8 page 7](#)).

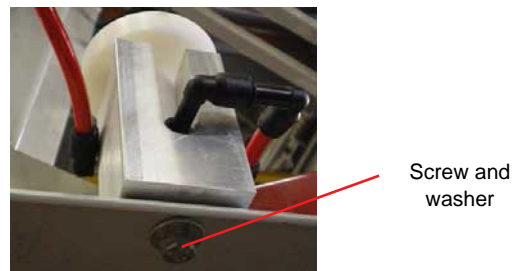

- Connect the “Fast Clean” to the cart air supply with pneumatic unions (items A and B) and hose (item 1), ([see § 8 page 7](#)).

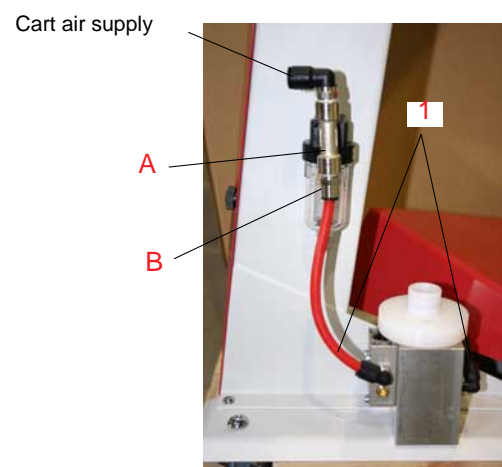

6.2. Fitting “Fast Clean” on a “Mach-Jet” cart

Drill a 9 mm diameter hole on one side of the “e-Jet” cart, for assembling the “Fast Clean” at the position indicated, next to the vibrating table.



- Secure the “Fast Clean” with an M8 x 85 bolt, flat washer and lock washers, ([see § 8 page 7](#)).
- Connect the “Fast Clean” to the cart air supply with pneumatic unions (items A and B) and hose (item 1), ([see § 8 page 7](#)).

7. Maintenance



WARNING : Cleaning operations must only be carried out using compressed air of maximum pressure 2.5 bar and a cloth. Water and solvents must not be used to clean the equipment.

- Clean the outside daily with a compressed air gun and check the seal ([see § 8 page 7](#) item 9).

8. Spare Parts

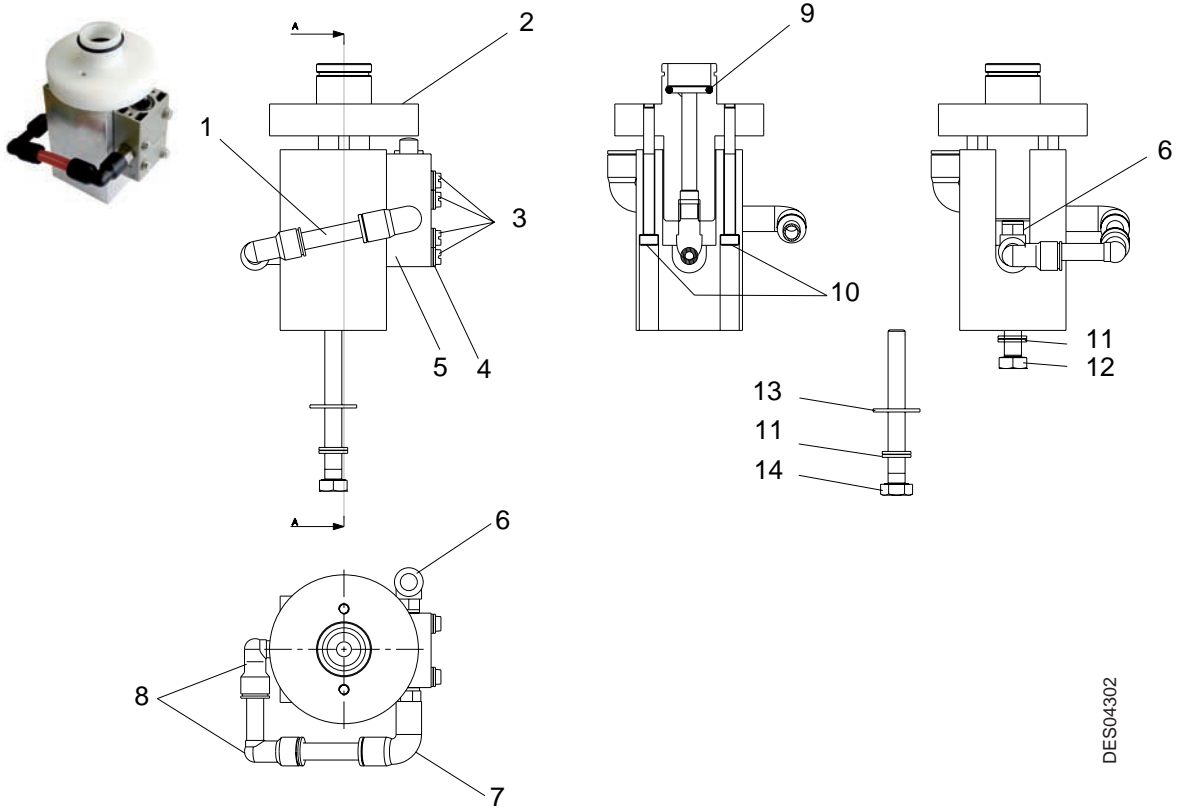

DES04302

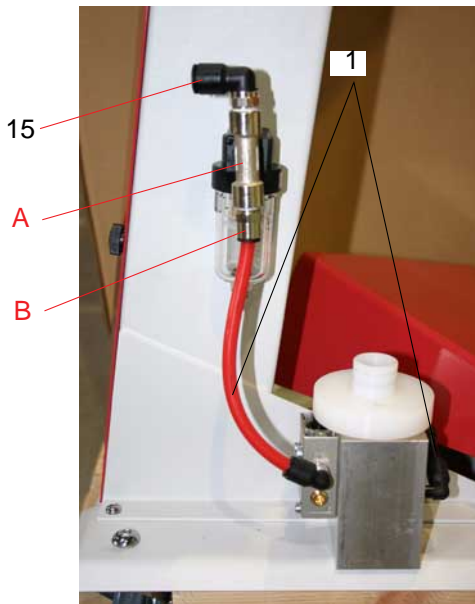

Item	Part number	Description	Qty	Unit of sale	Spare Part Level (*)
	1527409	Fast Clean	1	1	3
1	U1GRBW197	Polyurethane hose 6/8	0,1	m	2
2	1315678	Valve control pin	1	1	2
3	X2BVCB125	Slotted round-head bolt	4	1	2
4	X3CDSP799	Self-locking washer, Dia.: 4	4	1	2
5	F1VPDC132	Distributor	1	1	2
6	F6RLCS207	Conical male union bracket	2	1	2
7	F6RLCS515	Conical male union bracket	1	1	2
8	F6RLDS413	Quick-release bracket	2	1	2
9	1412135	Powder pump connector seal	1	1	2
10	X3AVSY194	M 5 x 60 galvanized steel Allen-head screw	2	1	2
11	EU9000847	External tooth lock washer, Dia.: 8	2	1	2
12	X2BVHA280	H 8 x 16 galvanized steel screw	1	1	2
13	X2BDLU008	Flat washer	1	1	2
14	X2BVHA693	H 8 x 85 galvanized steel screw	1	1	2
15	F6RLCS204	Conical male union bracket	1	1	2
A	130000674	2 x 1/4 BSP female - 1/4 BSP male nickel plated branch tee	1	1	2
B	F6RLUS199	Male union	1	1	2

(*)

Level 1: Standard preventive maintenance

Level 2: Corrective maintenance

Level 3: Exceptional maintenance